

○各校における教室等の配置状況一覧

NO.1 1・12関連

学校名	普通教室	多目的室 小人数教室	教室数 総計	再配置後 学級数 2040推計	特別教室等で普通教室化や他の利活用が考 えられるもの	複合化済み施設
寒川小学校	20	6	26	14	ランチルーム	町民センター分室・児童ク ラブ
一之宮小学校	14	7	21	※1 24	ランチルーム・プレイルーム・閲覧室・生 活材室・焼窯室・英語教室・ホール	文化財学習センター・児童 クラブ
旭小学校	24	3	27	18	集会室	児童クラブ（別棟）
小谷小学校	16	2	18	12	生活科室・ランチルーム・展示ホール・特 活室	児童クラブ
寒川南小学校	19	6	25	※1 24	ふれあいホール・ランチルーム・1階ホー ル・オープンスペース（1F2か所）	児童クラブ（別棟）
寒川中学校	13	3	16	※2 15	学習室・ICT教室・作品室・1Fホール・シ アター紺碧・ギャラリー紺碧・スペースオ アシス・合唱室（3）・特活室	
旭が丘中学校	17	5	22	13	特活室（2）・教材室（2）・廊下スペー ス（2,3F）	
寒川東中学校	15	7	22	※2 15	作法室・スペース青空・多目的ホール	

(令和4年度 学校施設台帳より)

※1 一之宮小学校と寒川南小学校の再配置後学級数は、統合後の学級数としています。

※2 寒川中学校と寒川東中学校の再配置後学級数は、統合後の学級数としています。

令和4年度

平面図	縮尺	(1/600 A4)	0 5 1.0 1.5 2.0 2.5 m	学校名	寒川小学校	調査年度	都道府県			市町村			学校			整理番号	1820
							1	4	3	2	1	1	5	5	1		

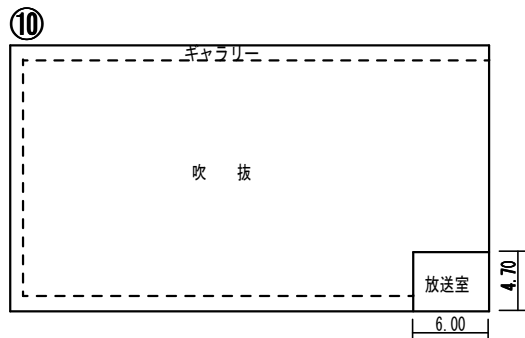

2階

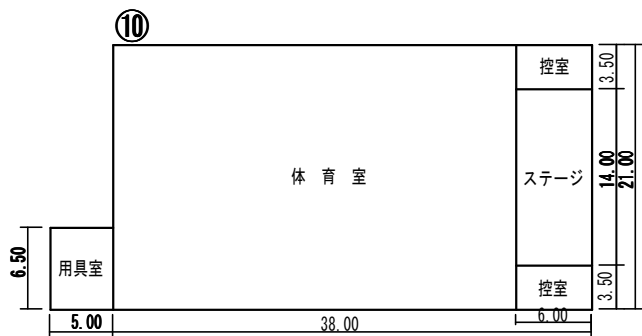

1階

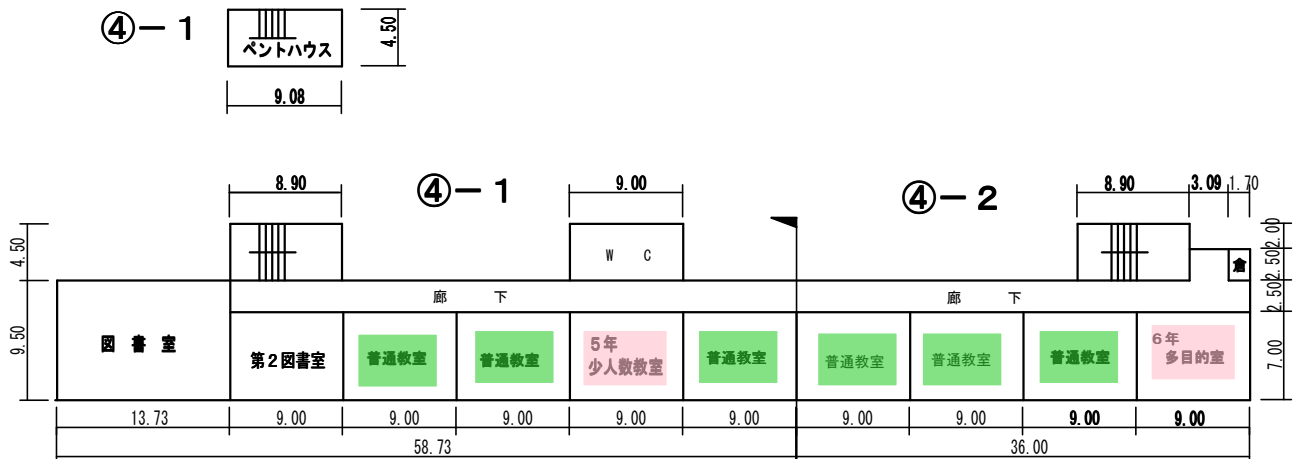
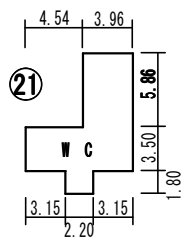

3階

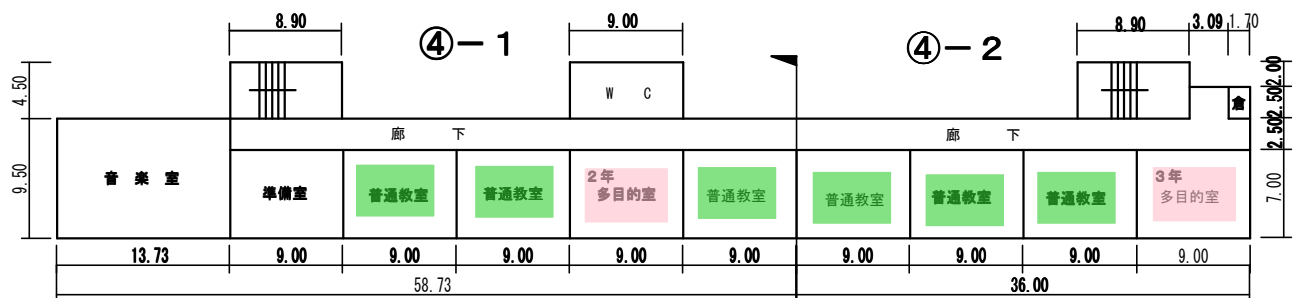

2階

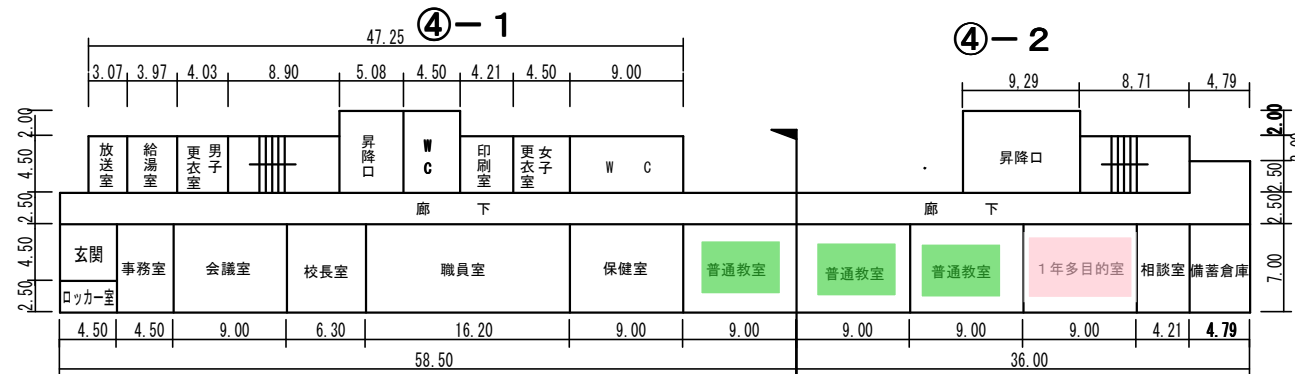

1階

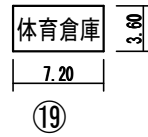
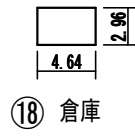
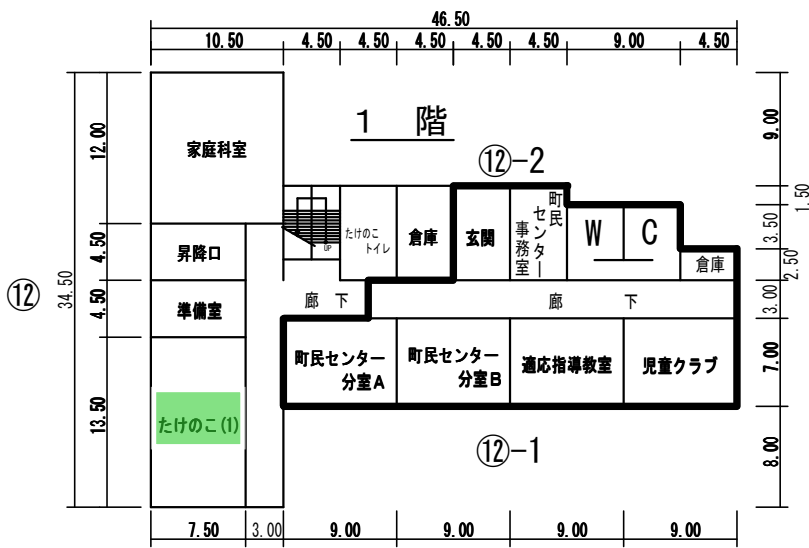
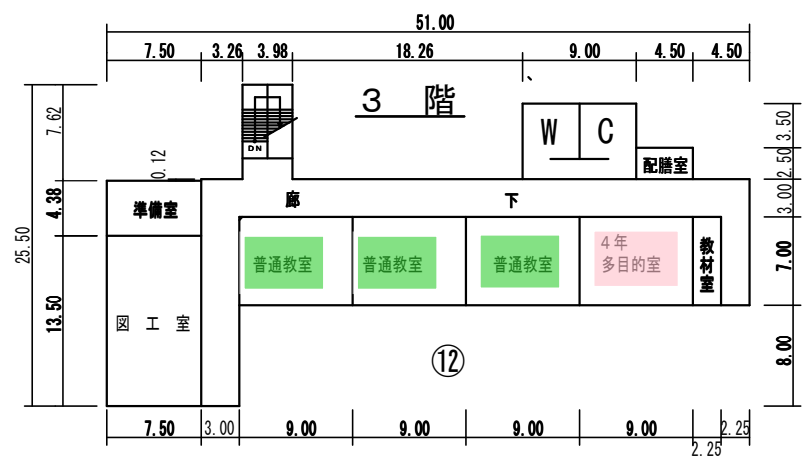
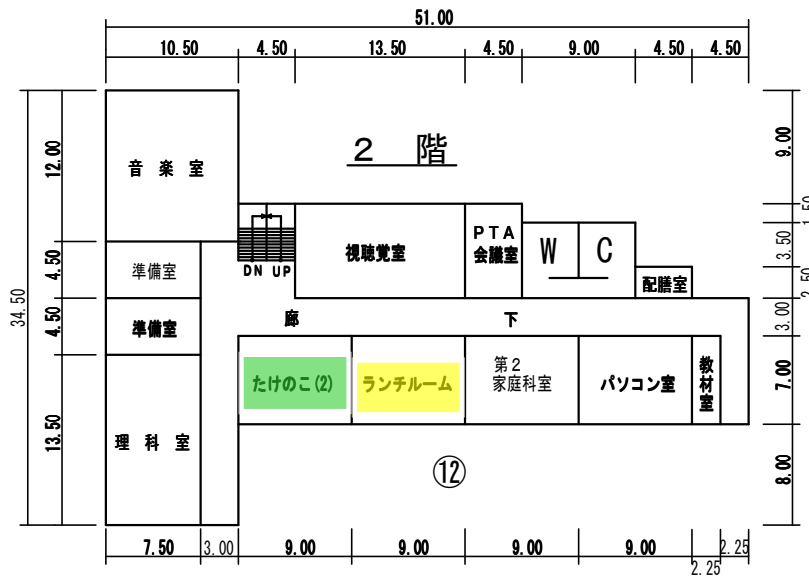

⑮プール専用付属 81㎡

平面図

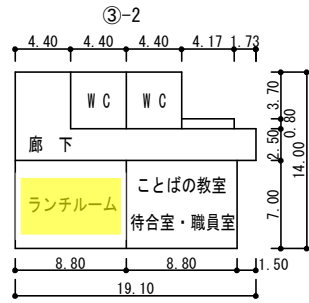

3 階

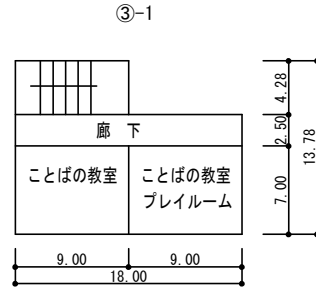

3 階

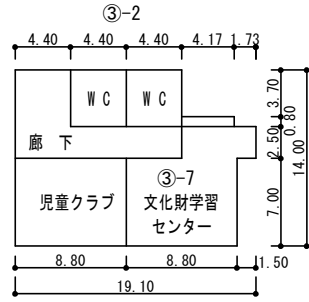

2 階

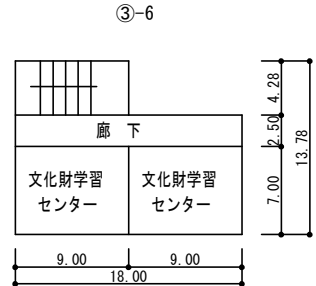

2 階

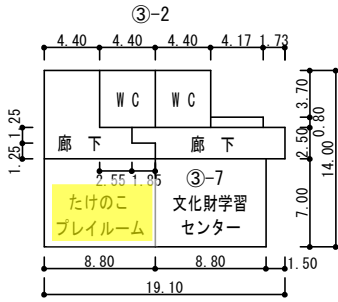

1 階

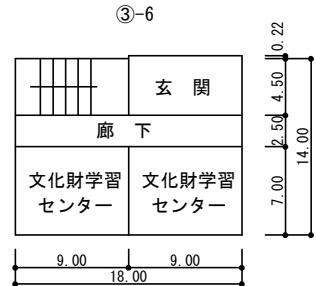

1 階

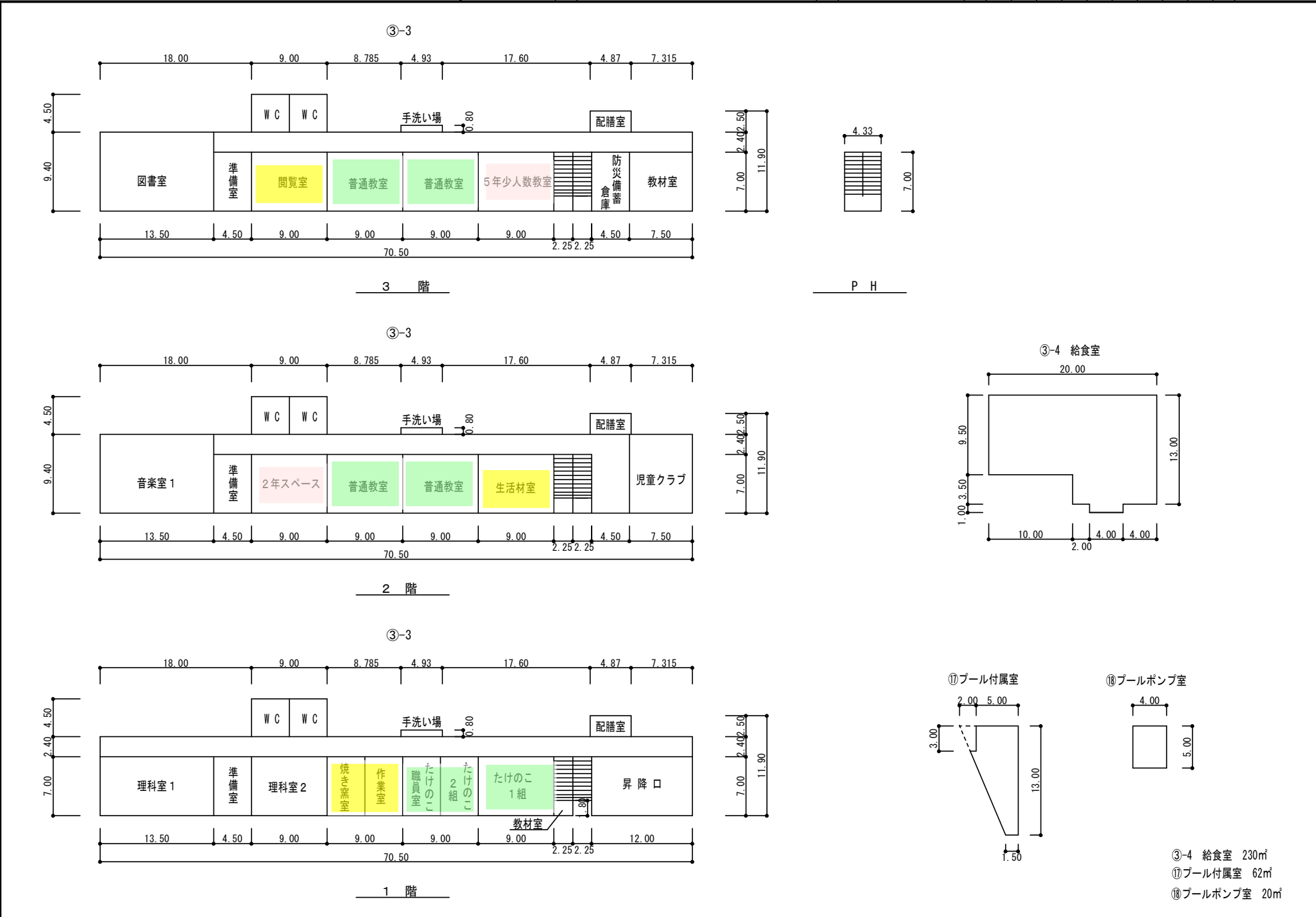

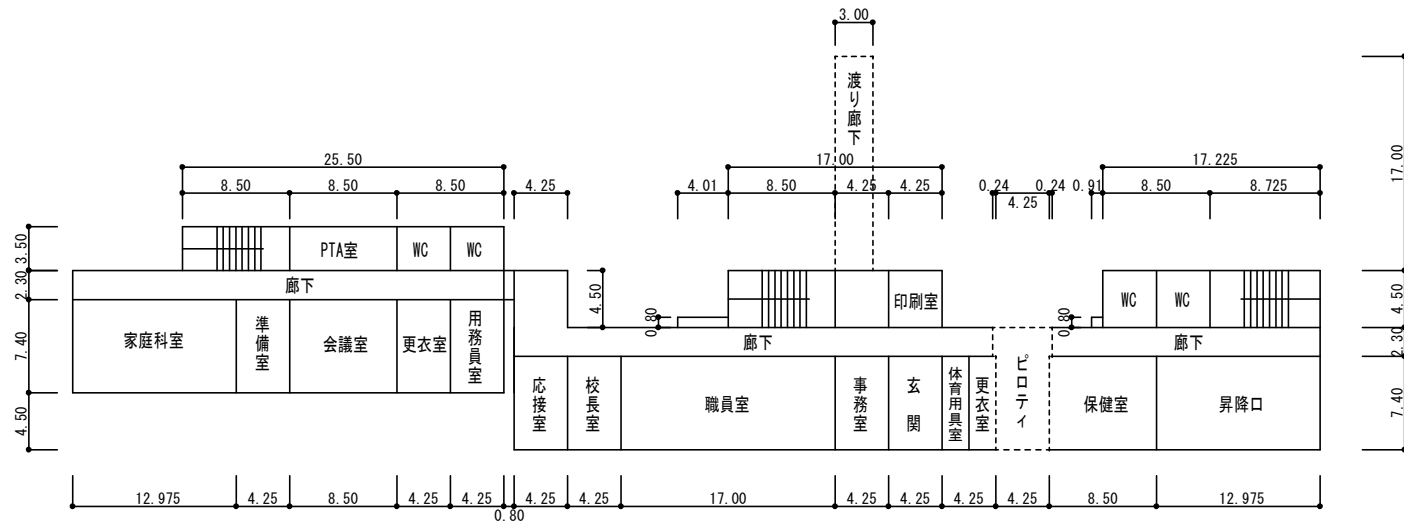
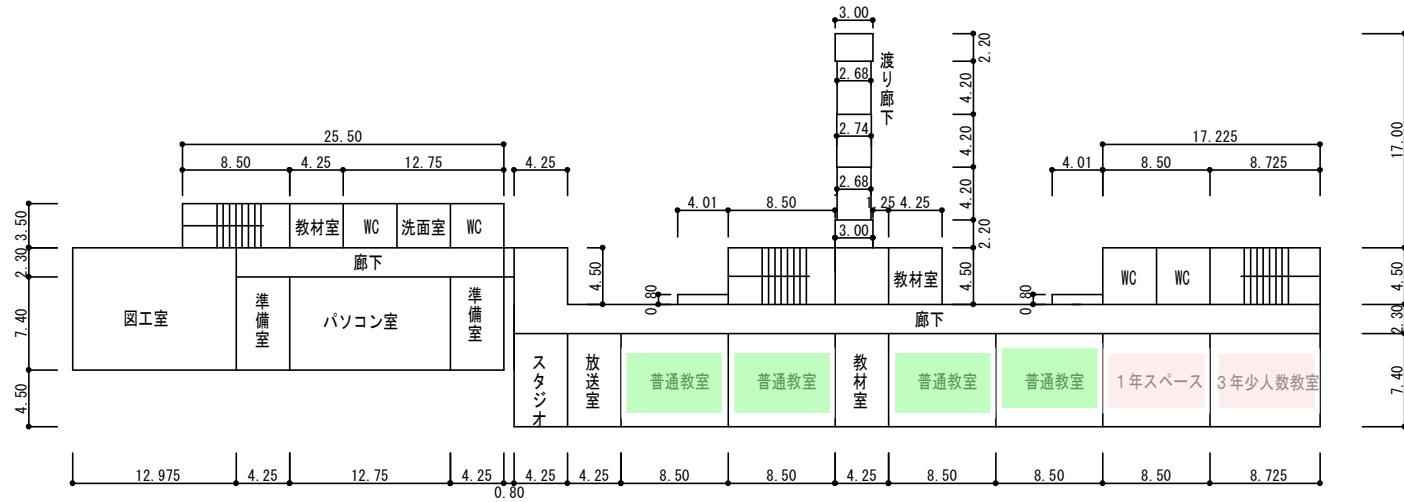

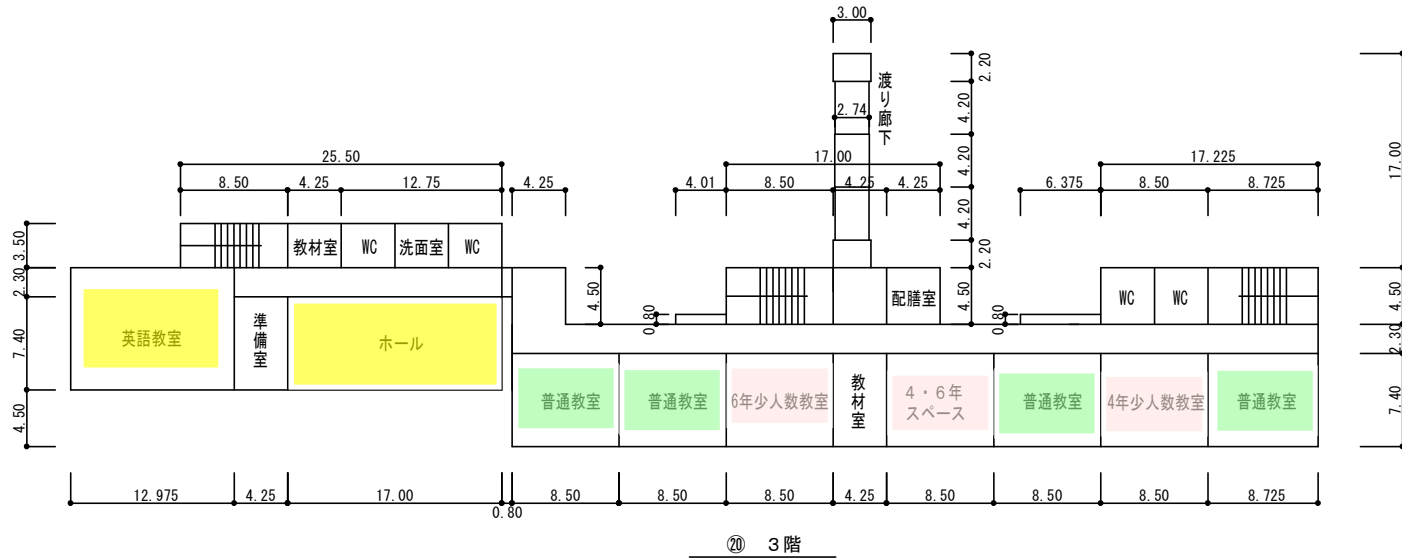
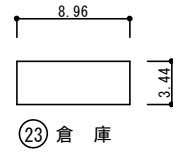
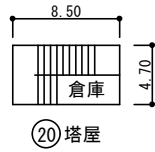
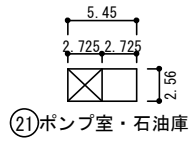

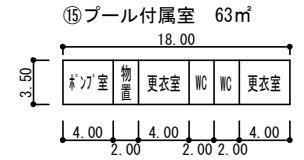
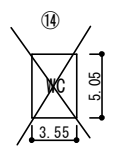
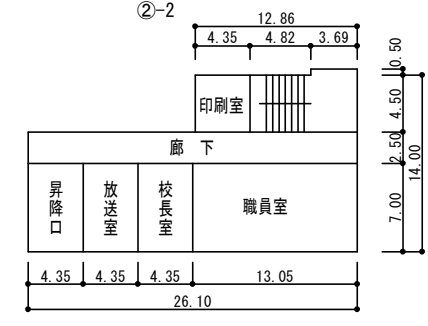
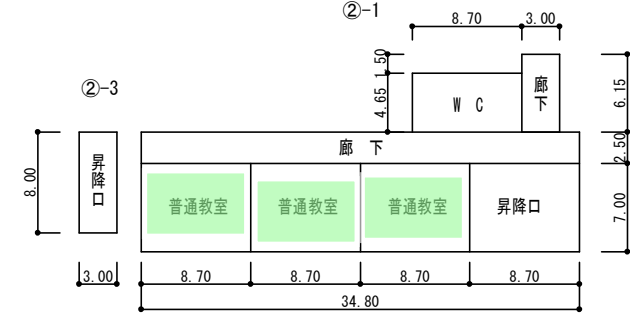
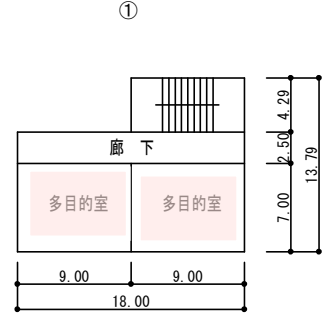
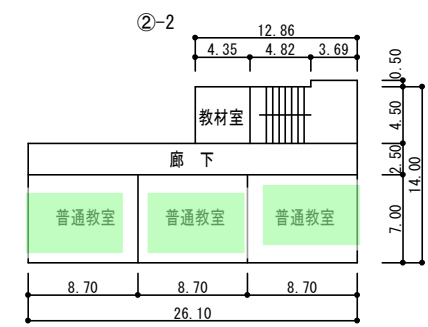
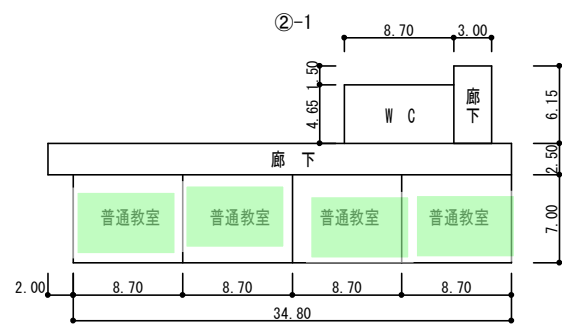
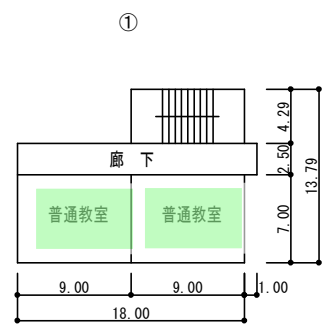
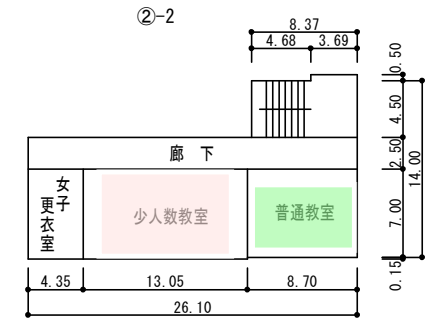
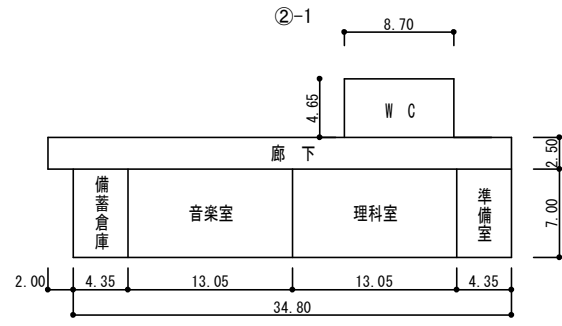
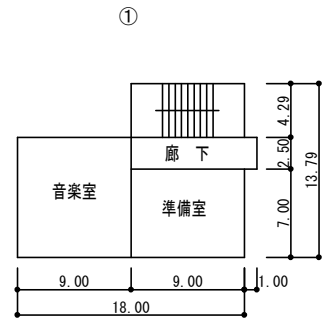

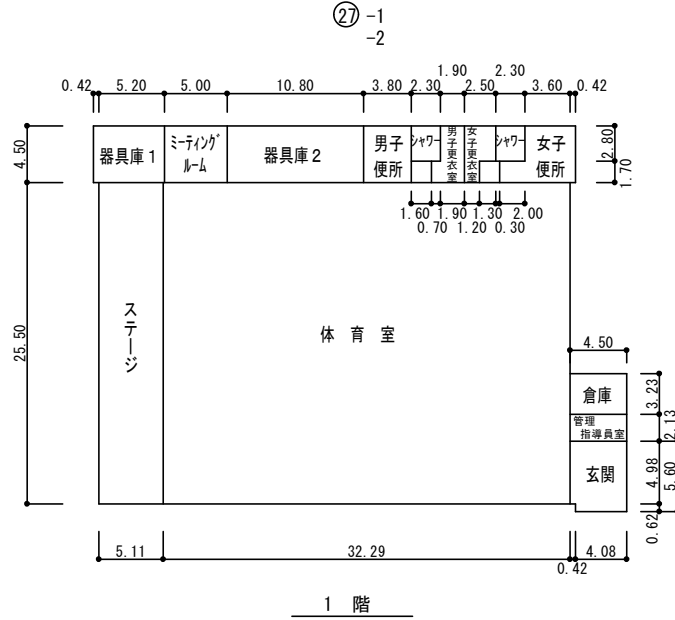
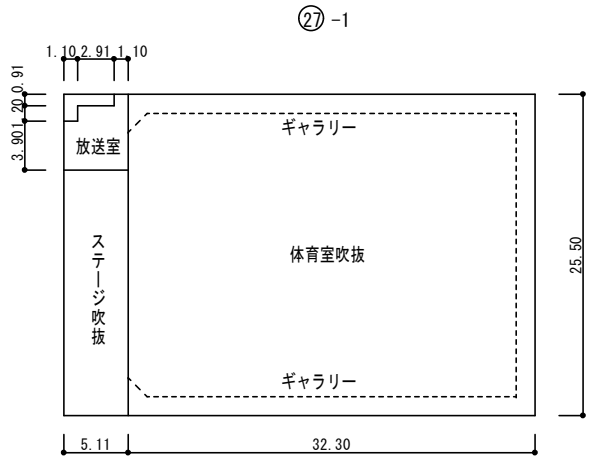
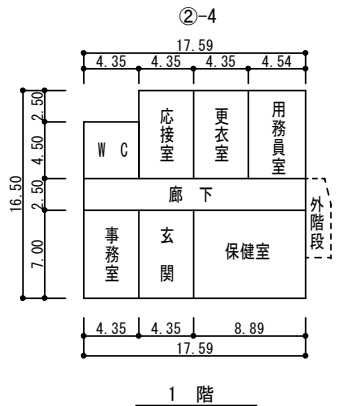
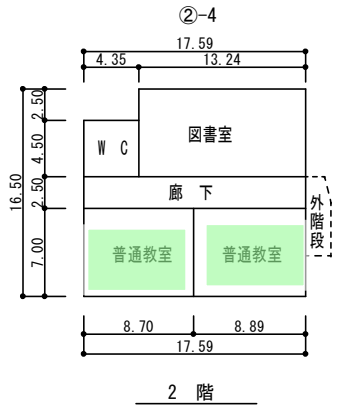
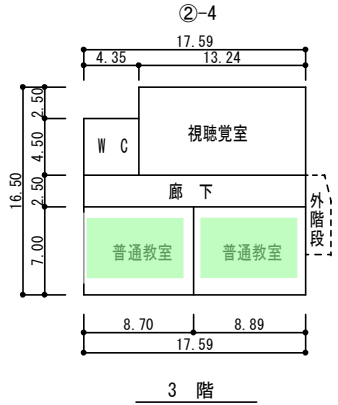

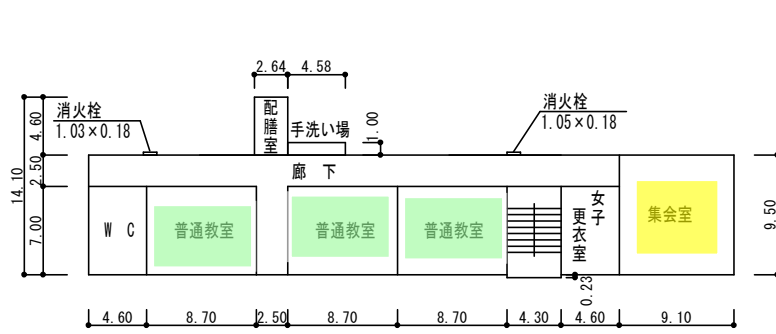

⑩ 3階

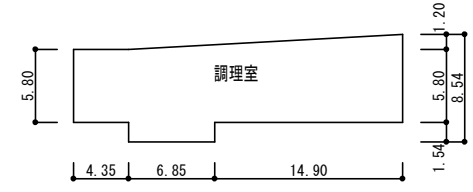

⑩-2 給食室

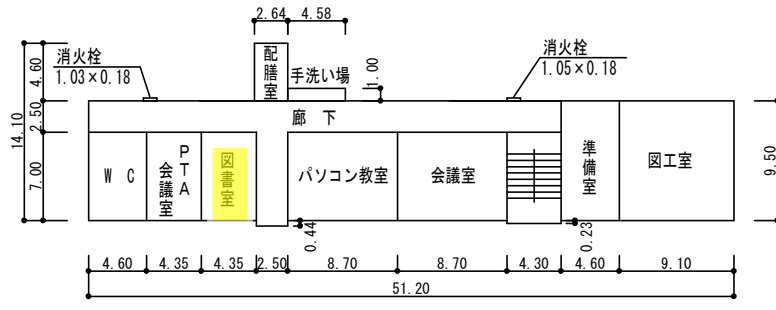

⑩ 2階

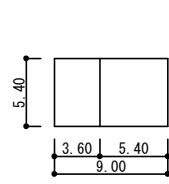

⑳ 倉庫

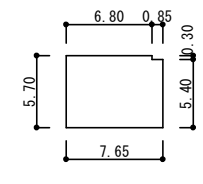

㉒ 休憩室

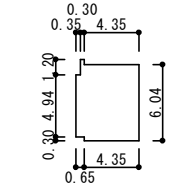

㉓ 調理室

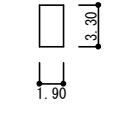

㉔ 倉庫

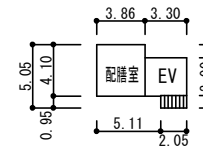

㉕ 1階

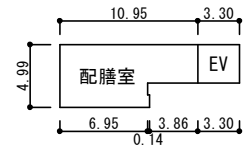

㉕ 2階

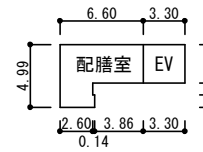

㉕ 3階

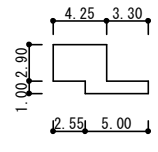

㉕ 地階 (EV機械室)

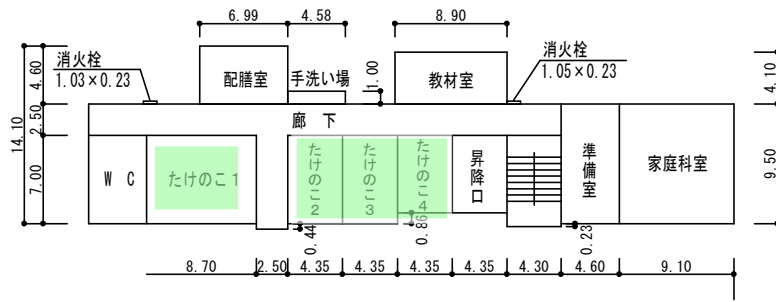

⑩ 1階

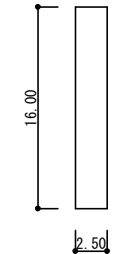

㉖ 2階

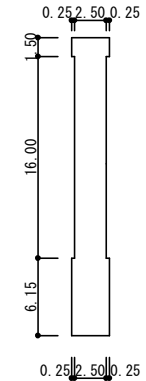

㉖ 3階

⑩-2
㉒ ㉓ ㉔
㉕
給食室
397㎡

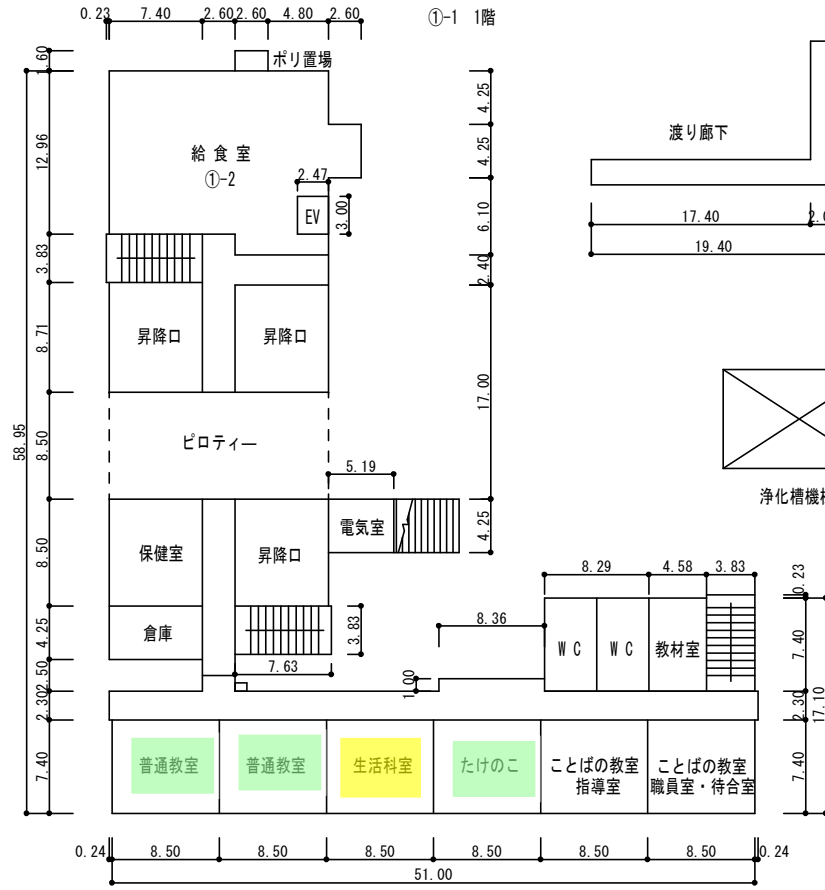

① 1階

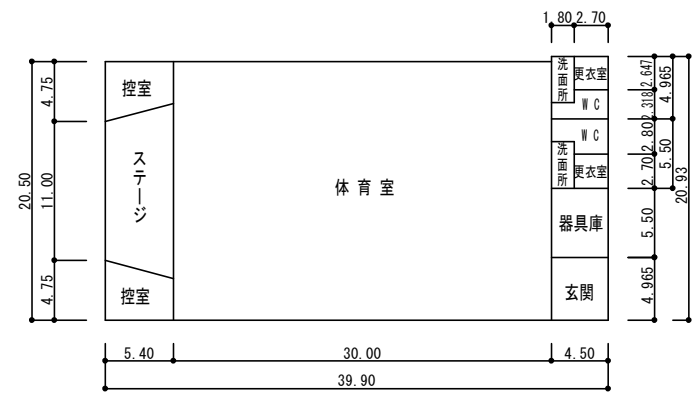
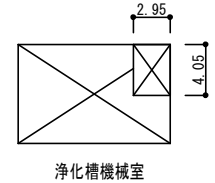
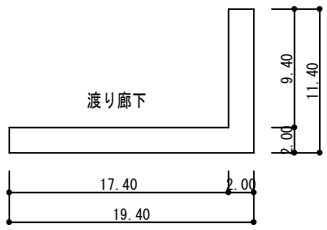
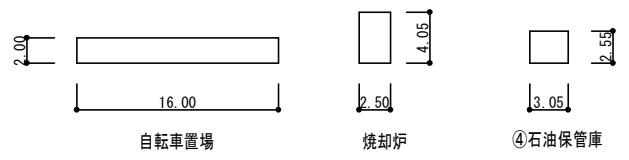

② 1階

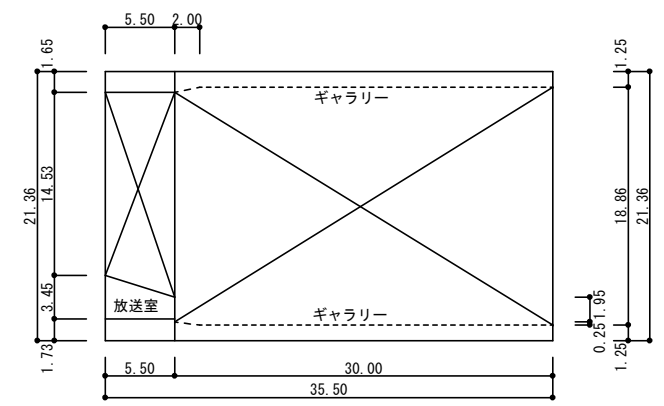

② 2階

通級指導教室 63㎡
給食室 247㎡

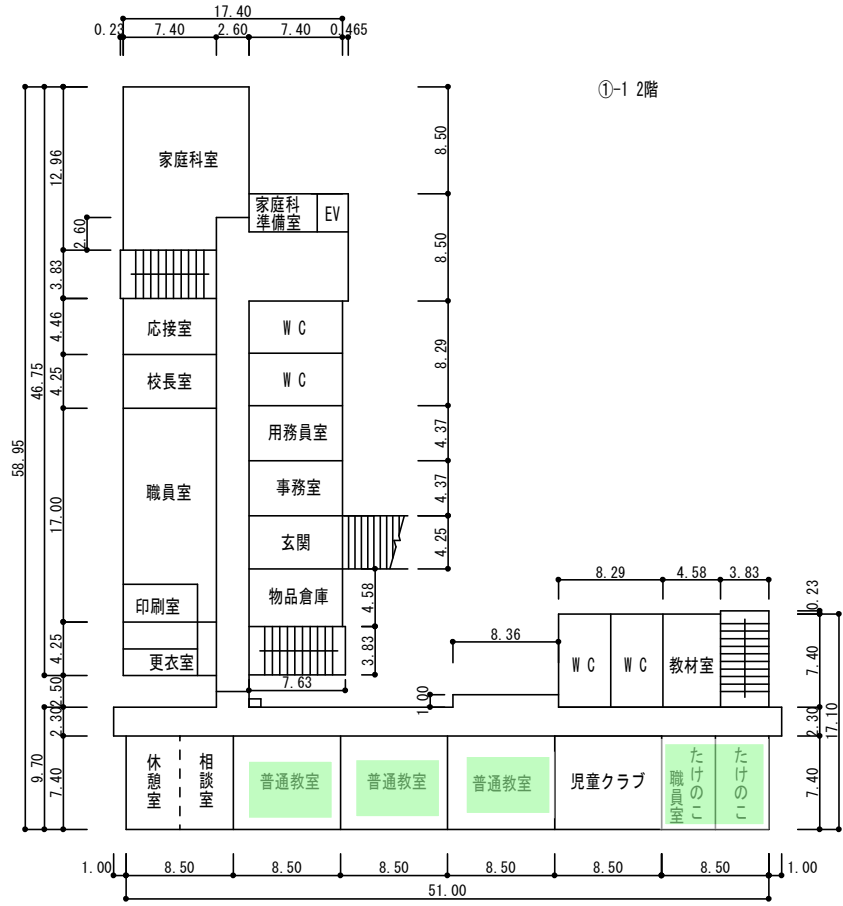

⑪ 2階

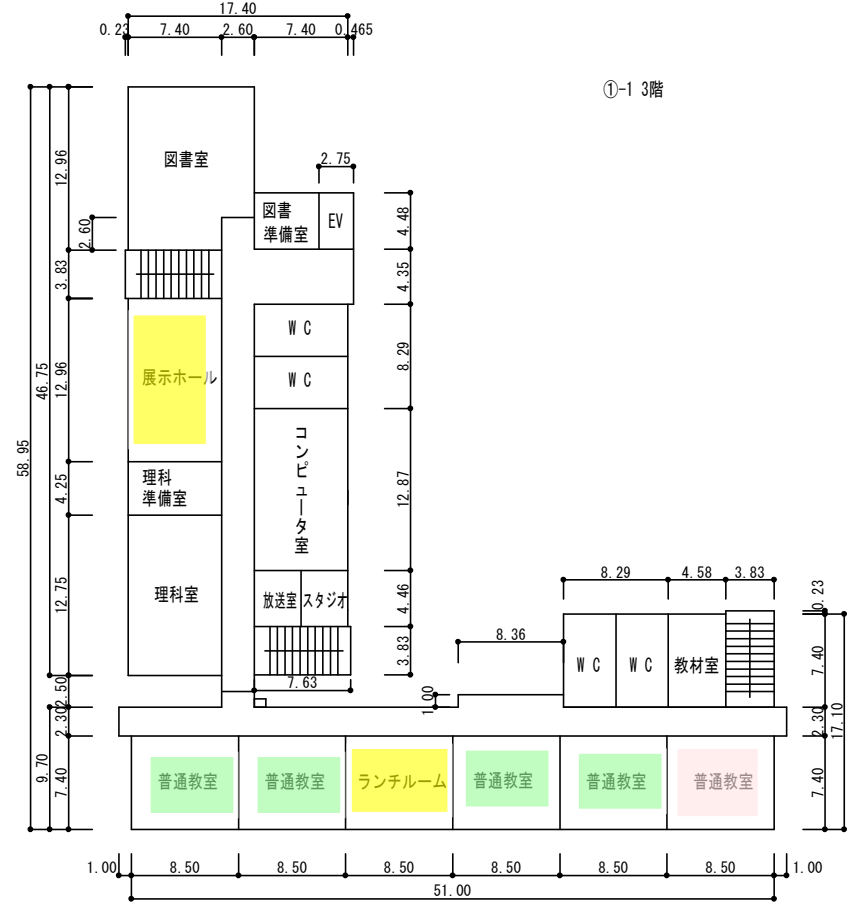

⑫ 3階

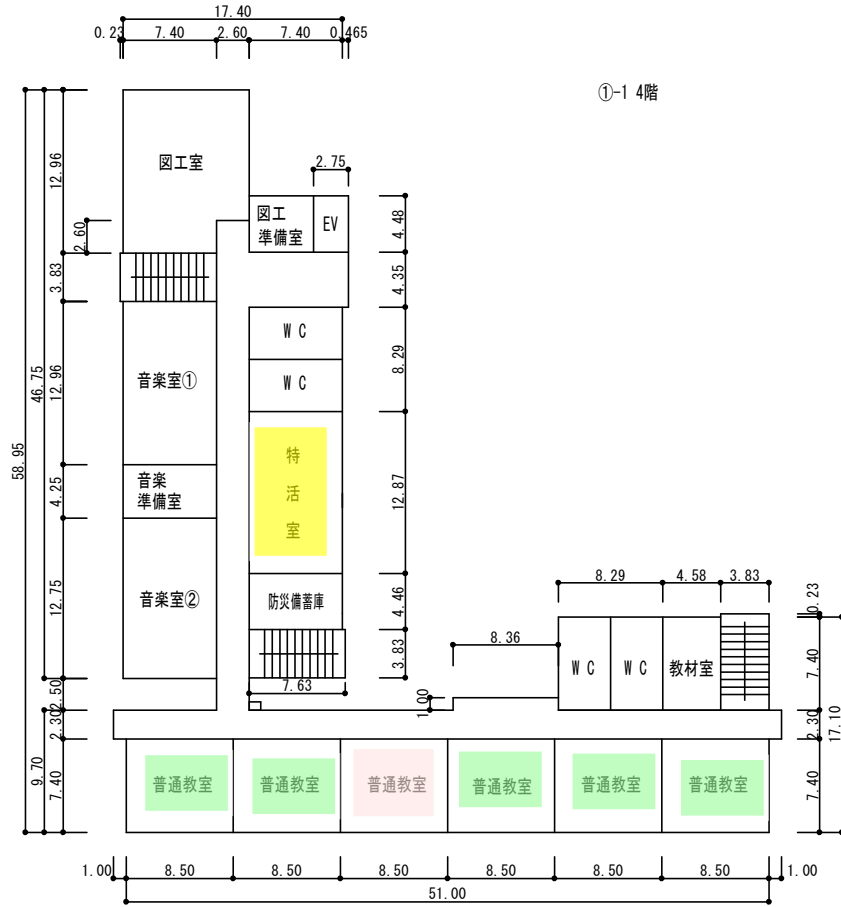

① 4階

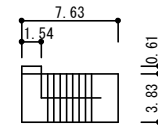
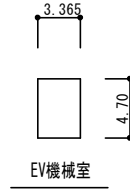

① 屋上階

令和4年度

平面図	縮尺	(1/600 A4)	0 5 10 15 20 25 m	学校名	南小学校	調査番号	(都道府県)				(市町村)			(学校)			加算点数	1824
							1	4	3	2	1	1	5	5	5			

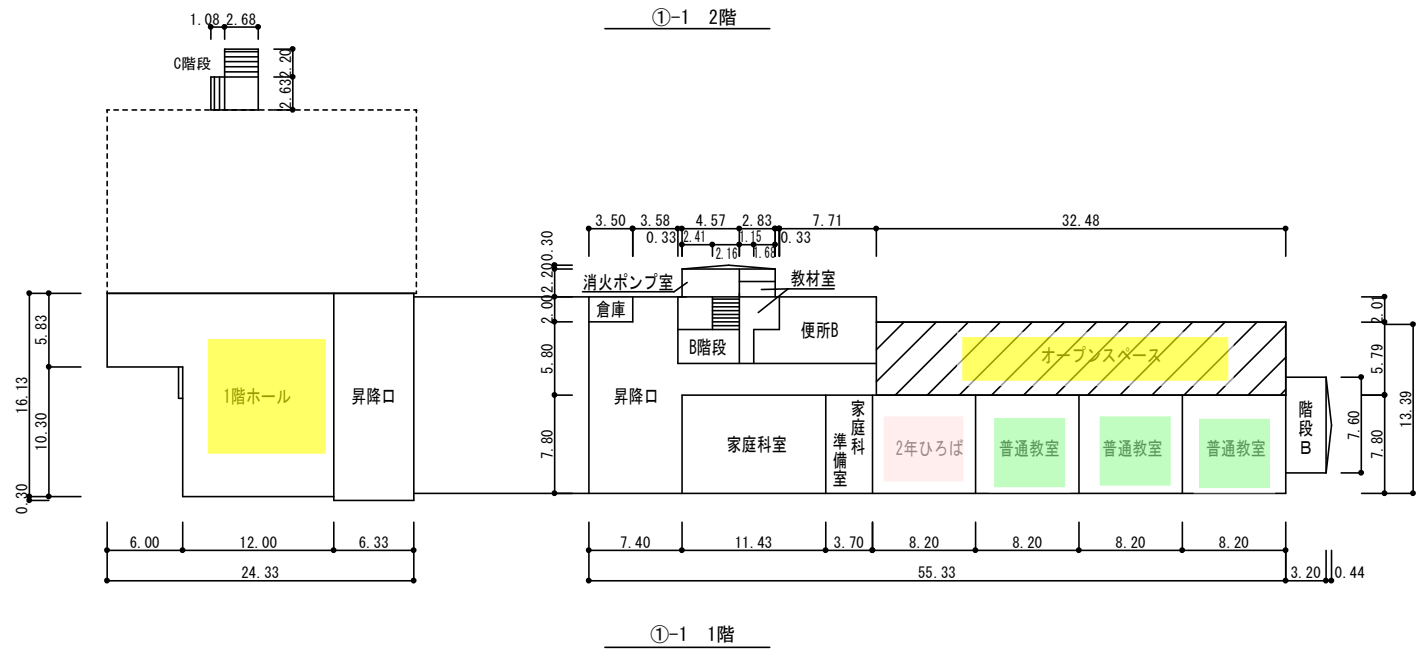
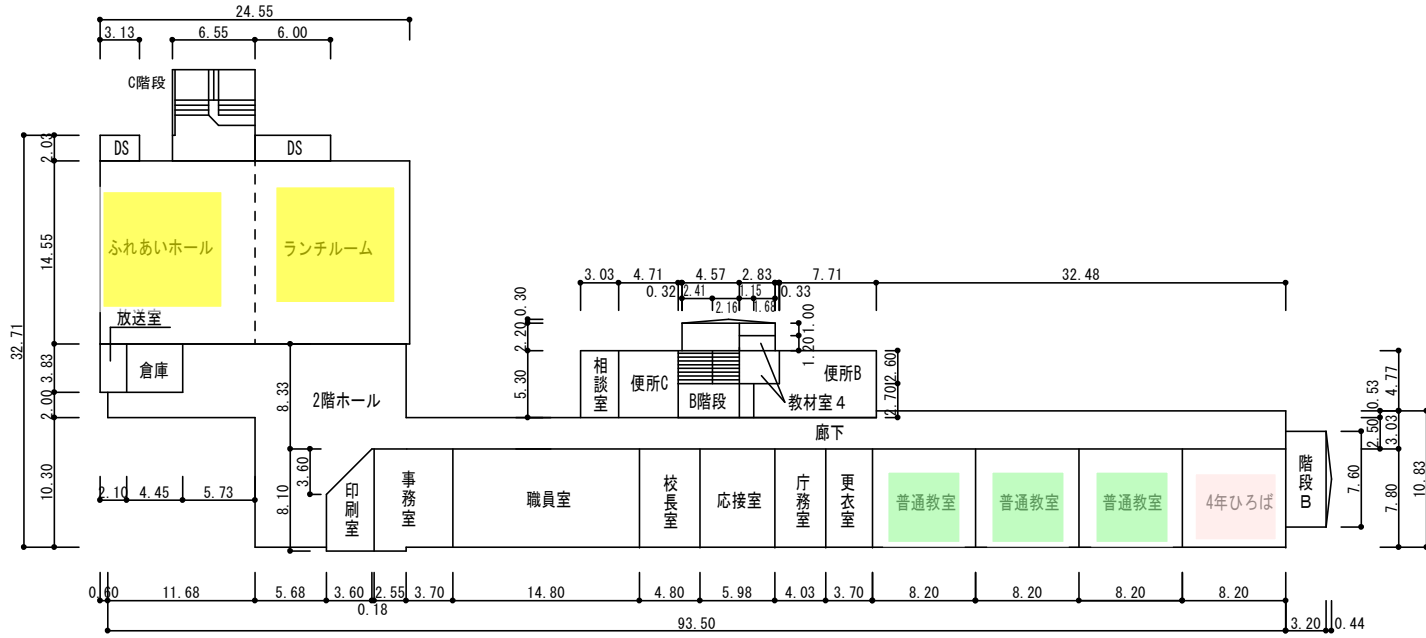

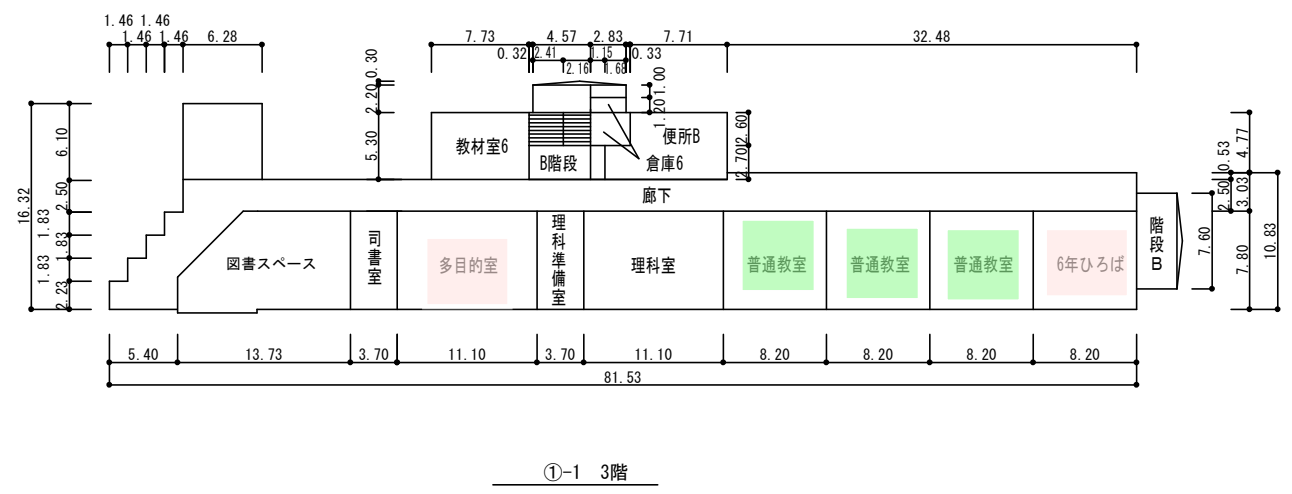
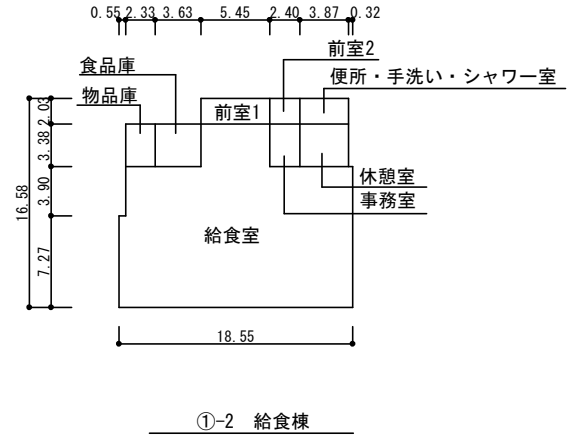
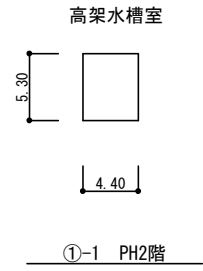
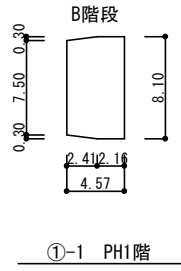

令和4年度

平面図	縮尺	(1/600 A4)	0 5 10 15 20 25 m	学校名	南小学校	調査番号				階数	1824			
						(都道府県)	(市町村)	(学校)						
						1	4	3	2	1	1	5	5	5

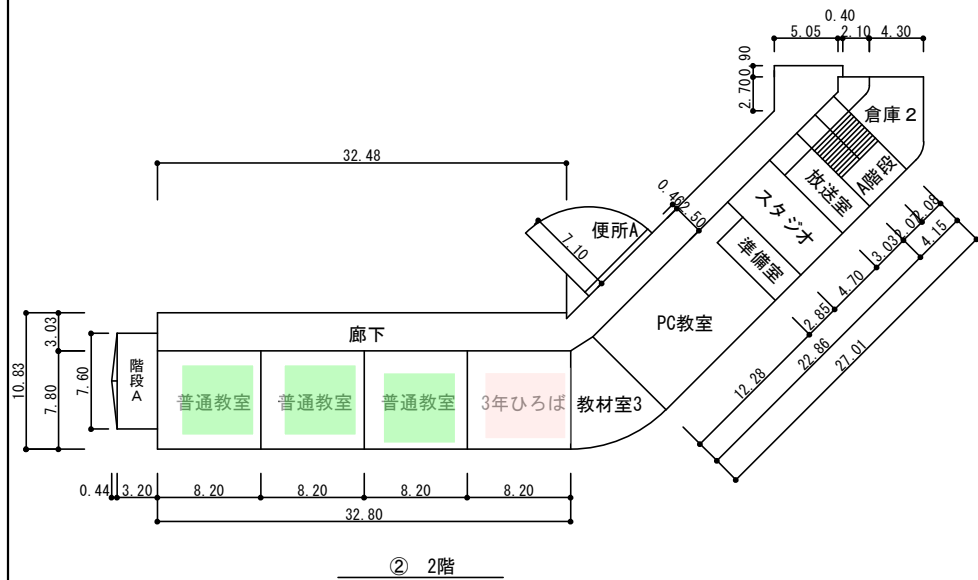

② 2階

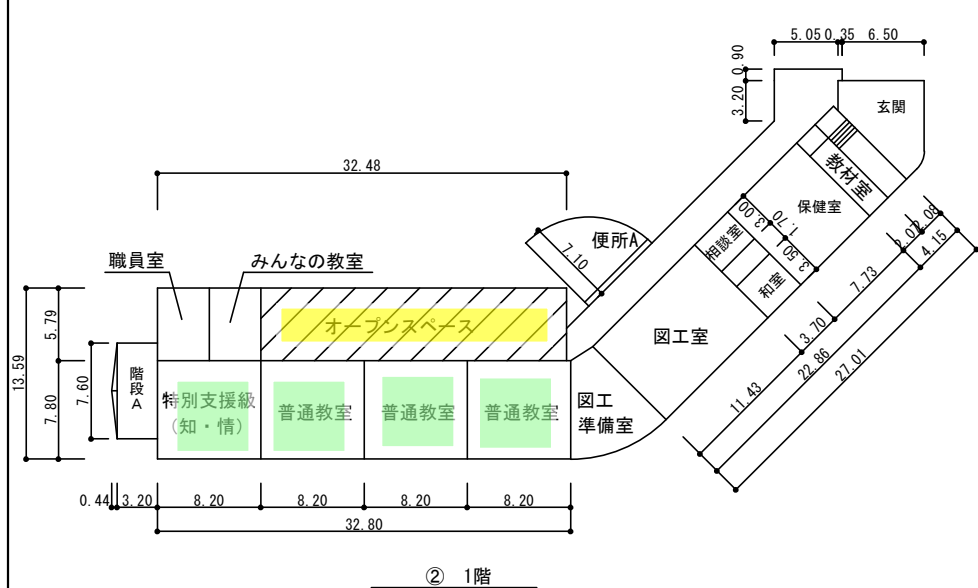

② 1階

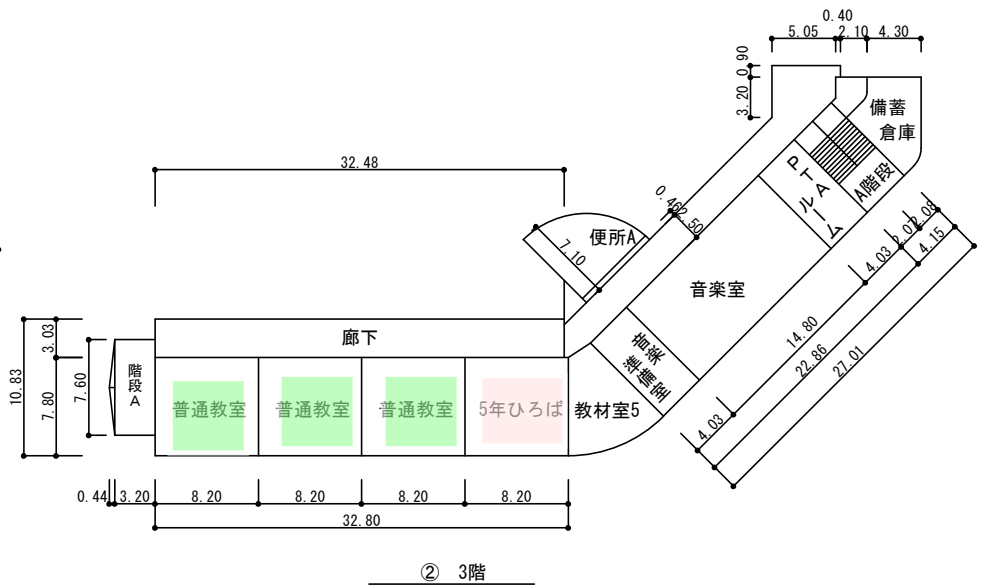

② 3階

令和4年度

縮尺	(1/600 A4)					学校名	寒川中学校	調査番号	(都道府県)			(市町村)			(学校)			加算幅数	1826
	0	5	10	15	20				25	m	1	4	3	2	1	4	4		

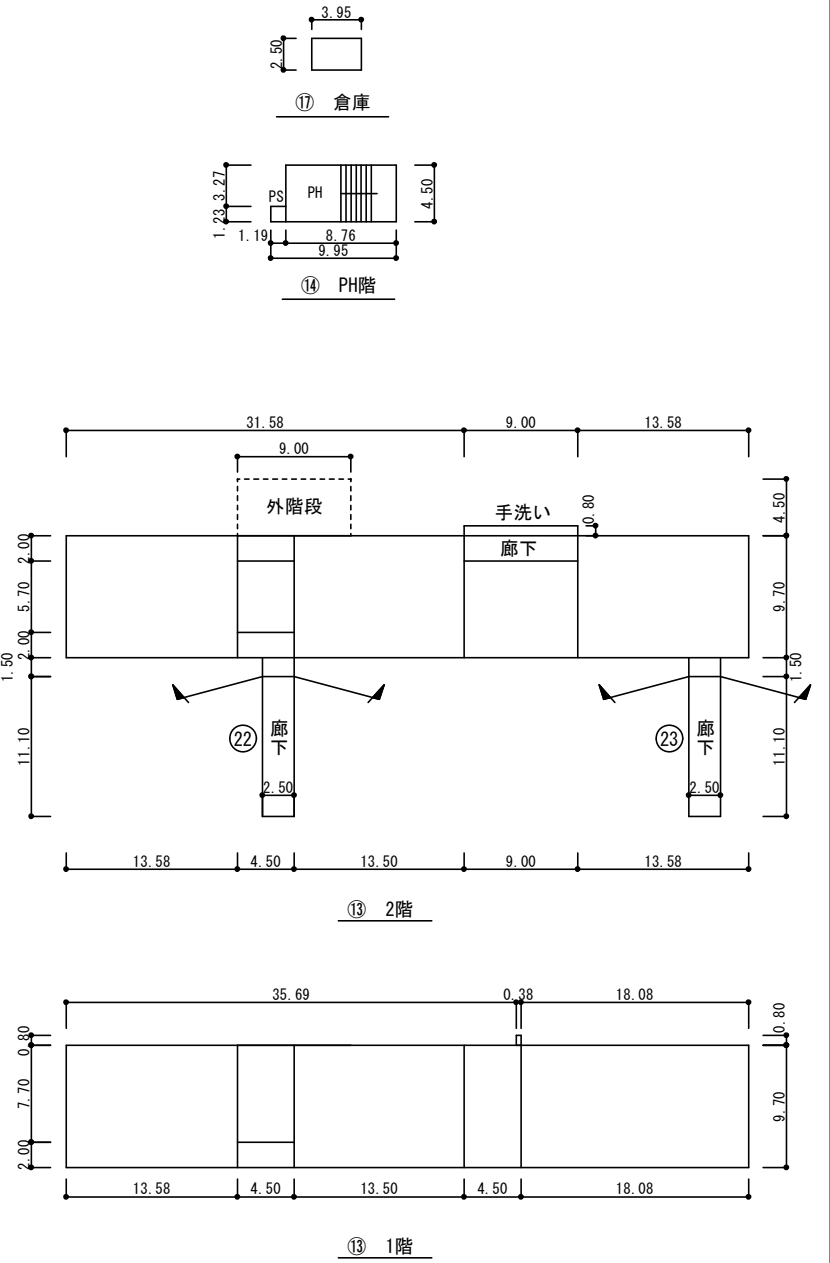
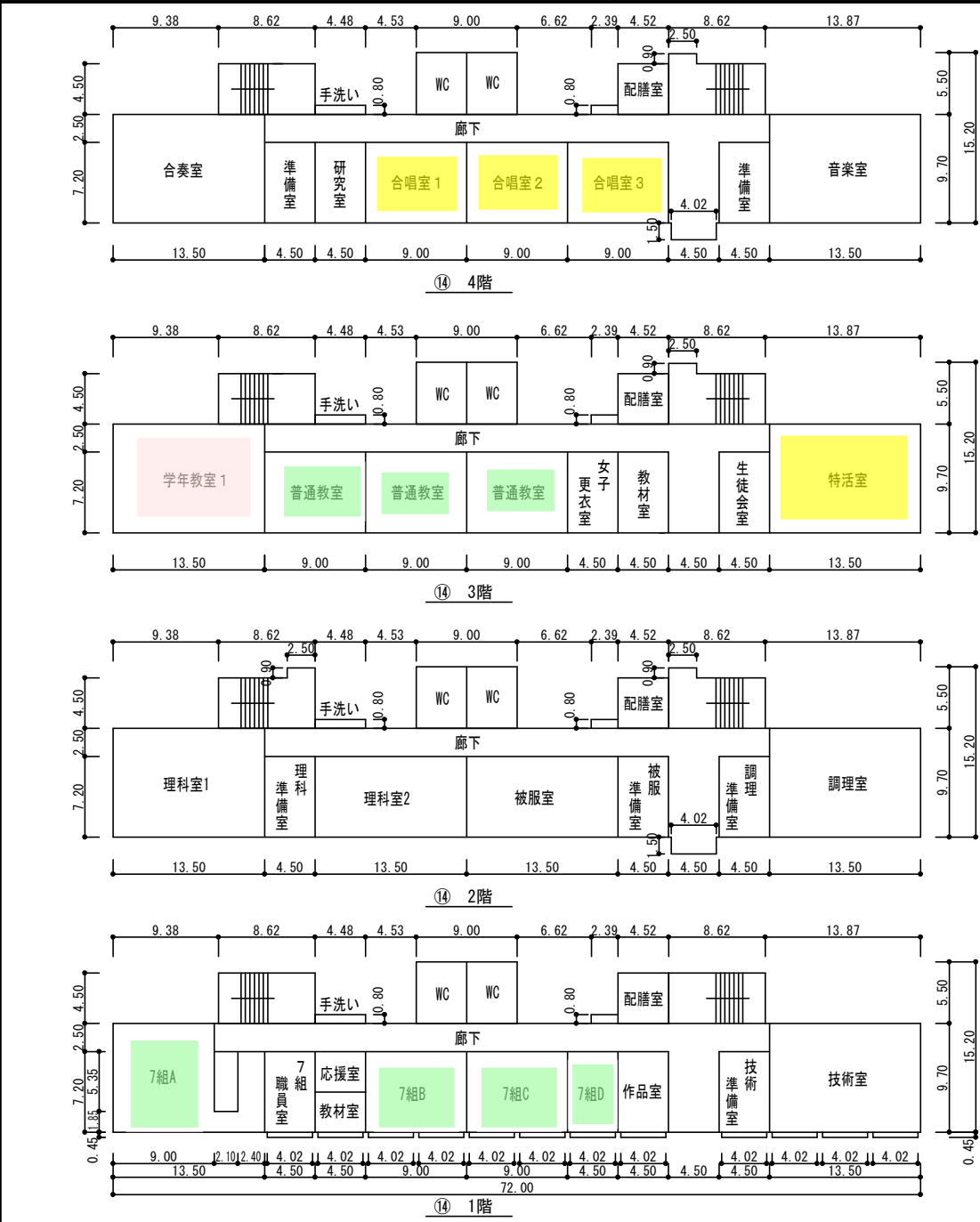

⑰倉庫学校開放施設 10㎡

令和4年度

縮尺	(1/600 A4)					学校名	調査番号			1826						
	0	5	10	15	20		25	m	寒川中学校		(都道府県)	(市町村)	(学校)			
平面図							1	4	3	2	1	4	4	6	1	

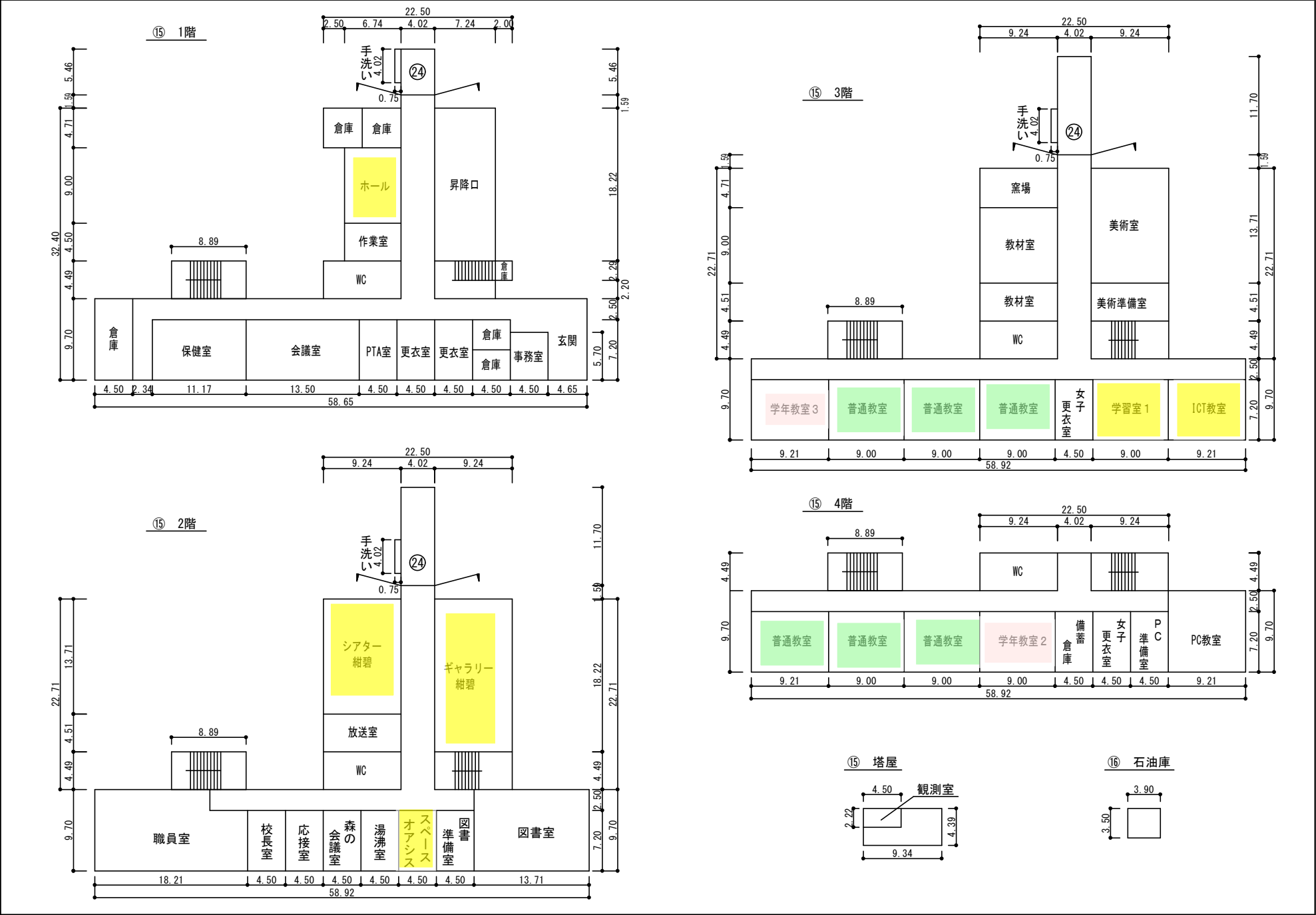

平面図

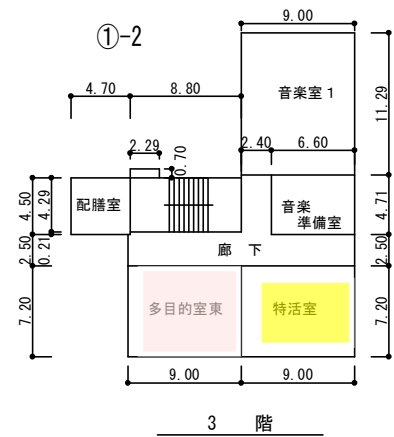
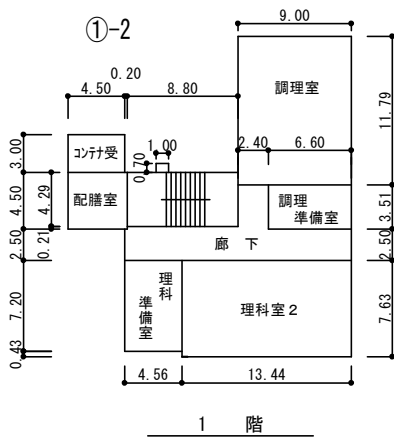
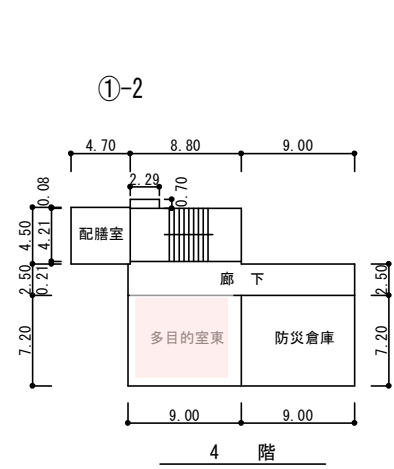
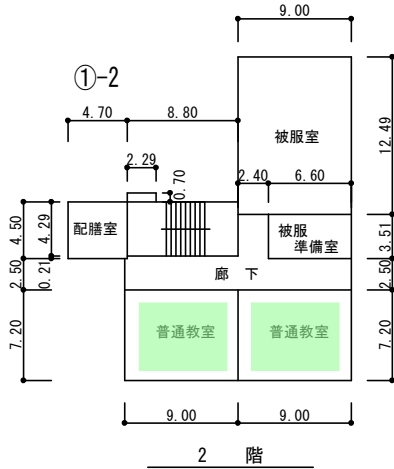
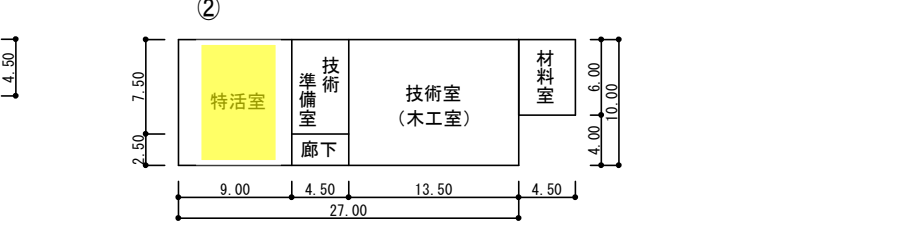
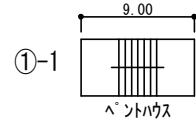
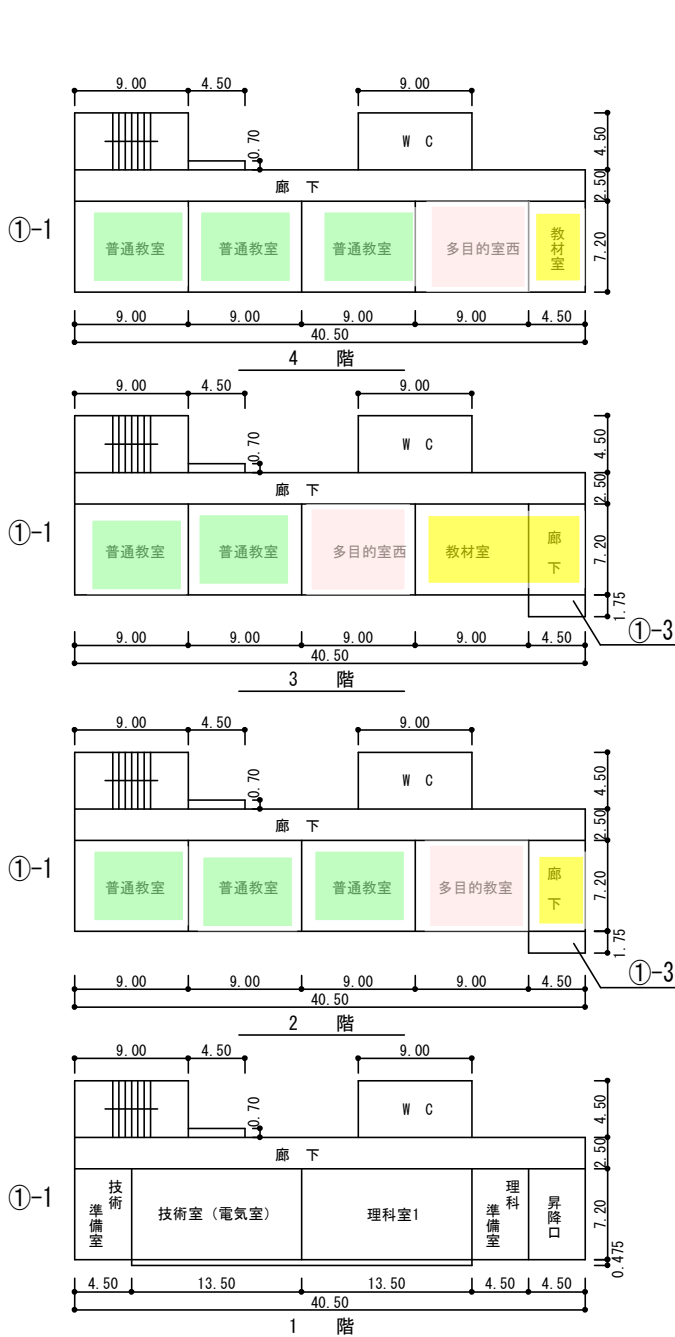

平面図

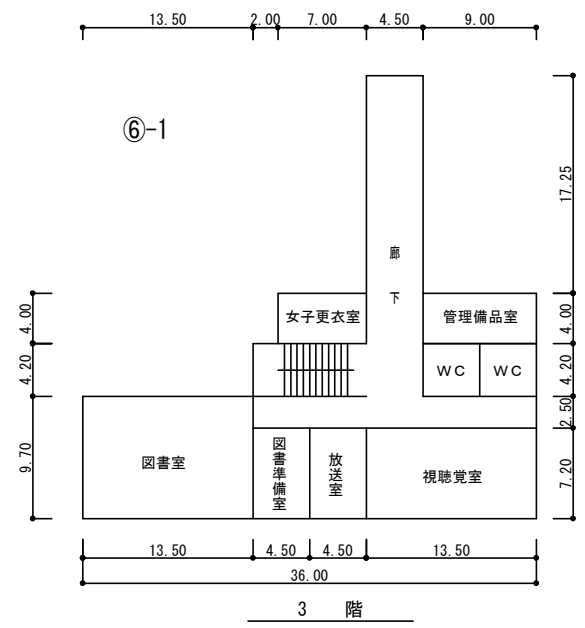
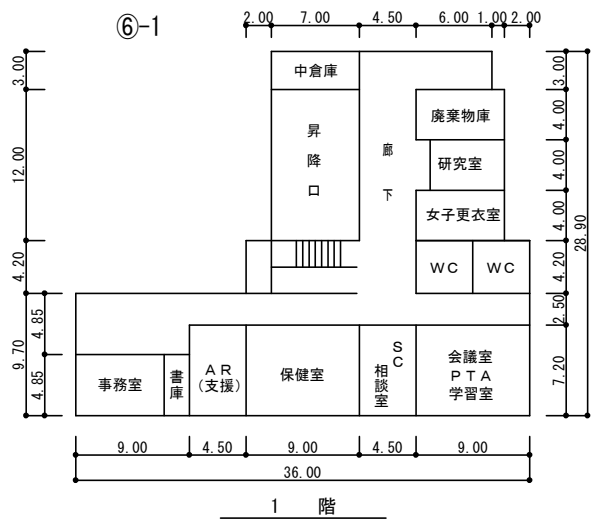
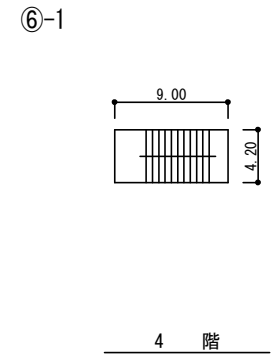
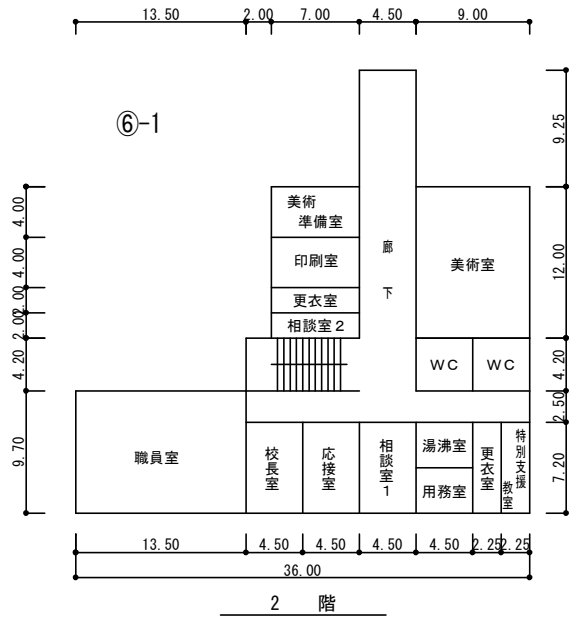

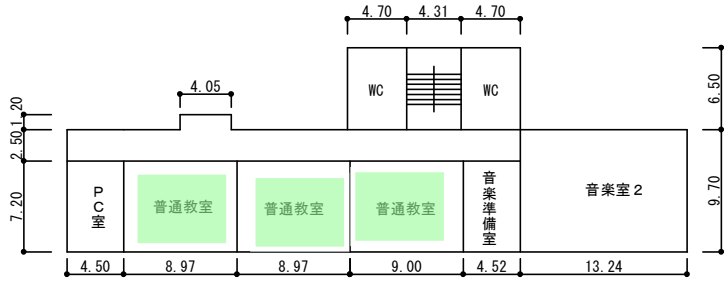

⑥-2 3階

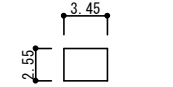

⑦ 倉庫

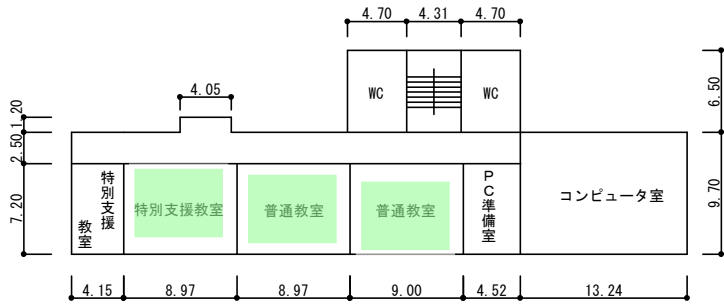

⑥-2 2階

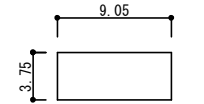

⑩ 倉庫

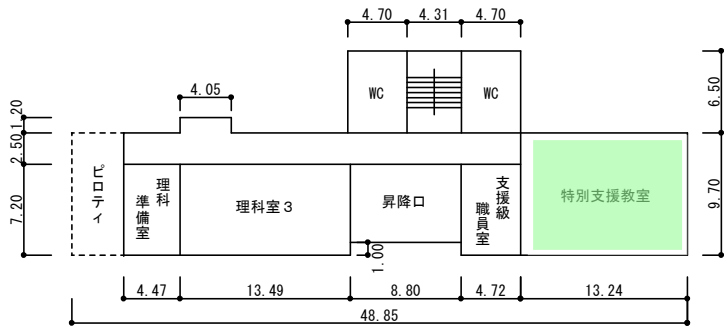

⑥-2 1階

⑦倉庫 (学校開放専用) 9㎡

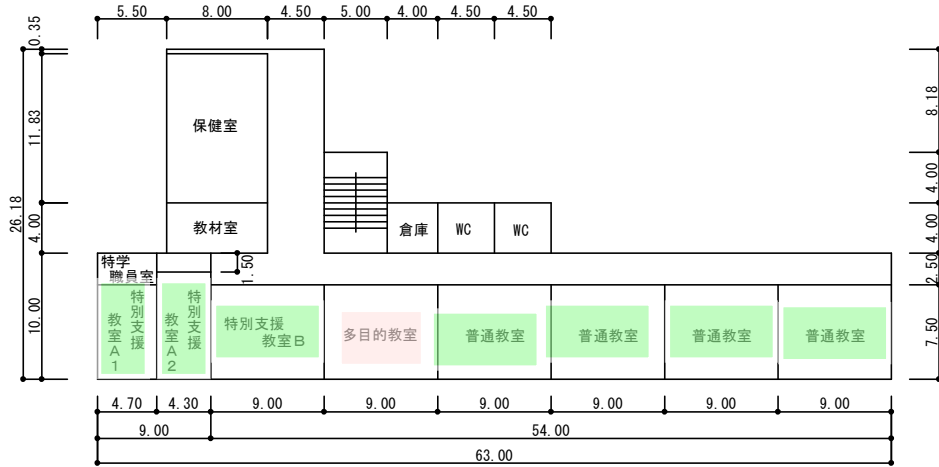

①-1 2階

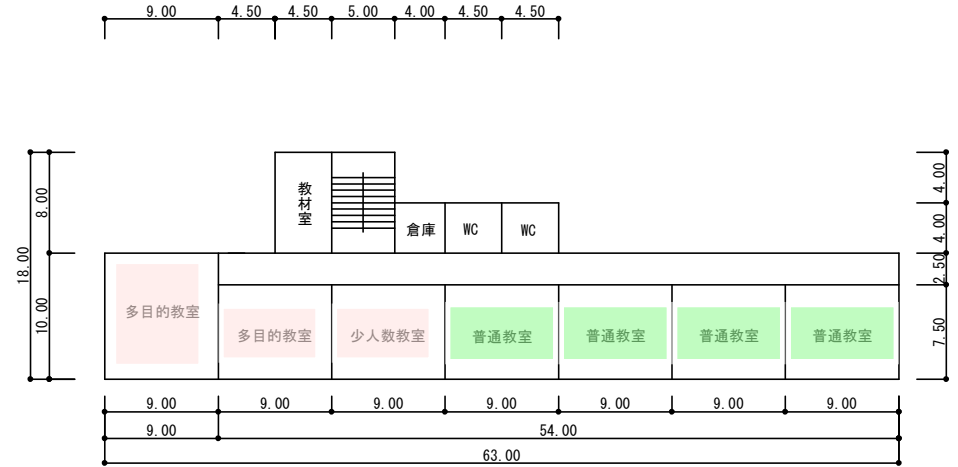

①-1 4階

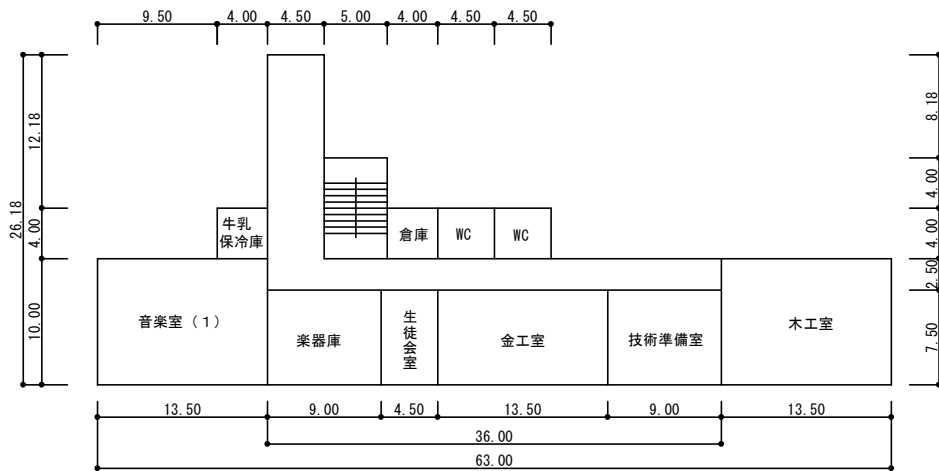

①-1 1階

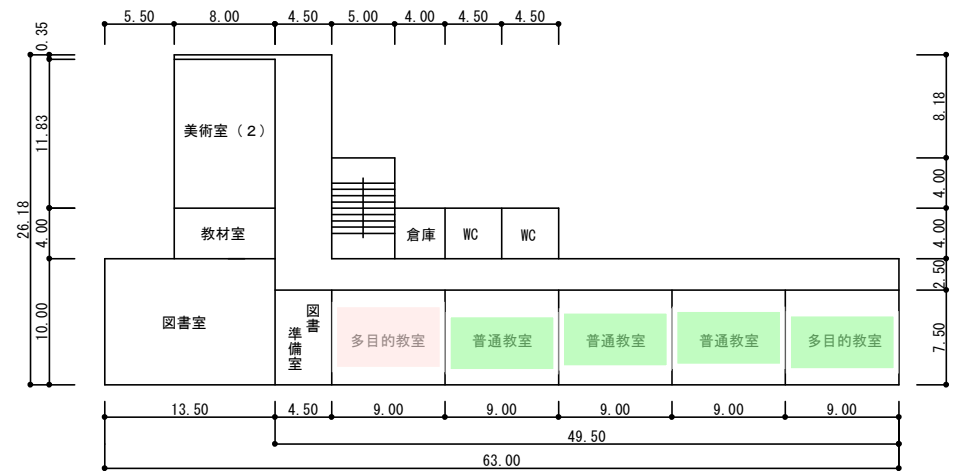

①-1 3階

令和4年度

縮尺	(1/600 A4)						学校名	寒川東中学校			調査番号	(都道府県)			(市町村)			(学校)			市町地区番号
	0	5	10	15	20	25		m	1	4		3	2	1	4	4	6	3	1828		

平面図

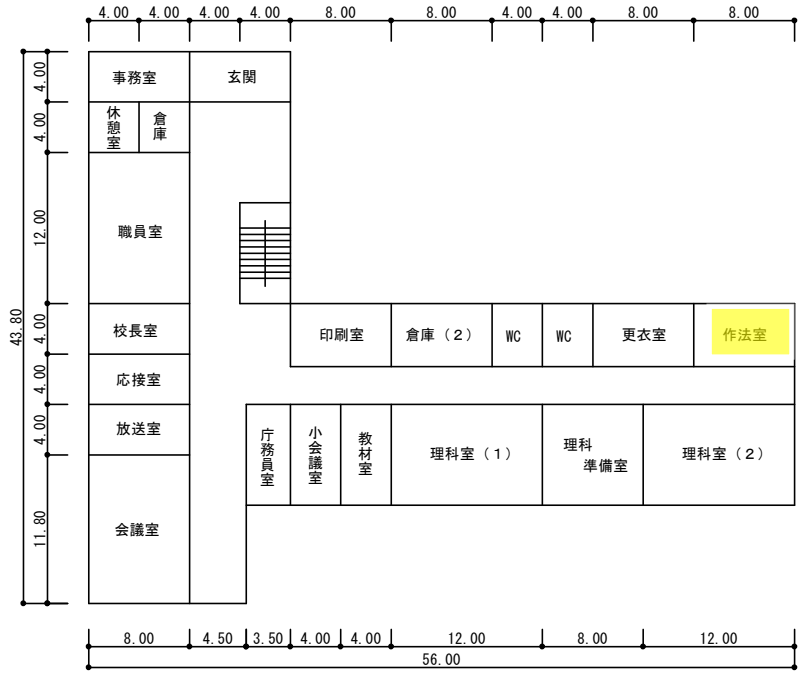

①-2 2階

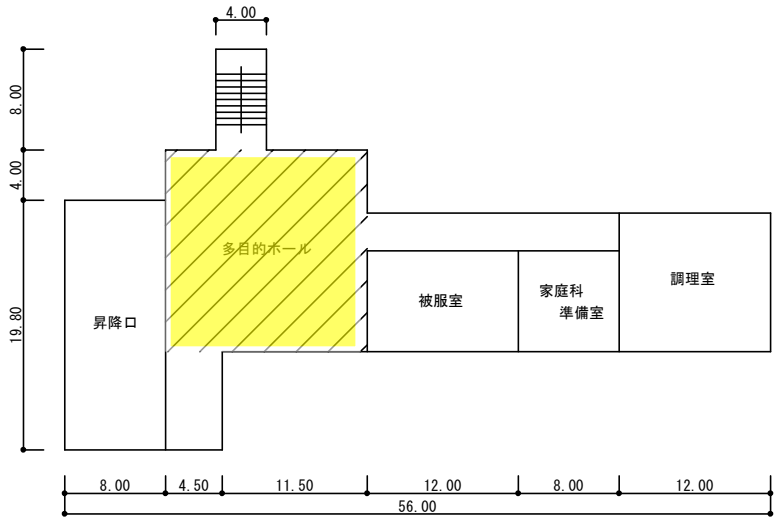

①-2 1階

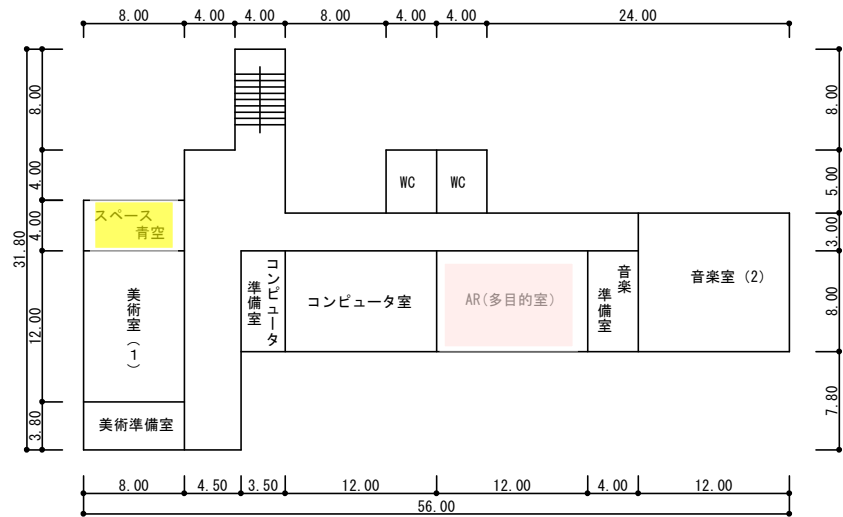

①-2 3階